

焊接式三通短型  
Welded Tee(short-type)

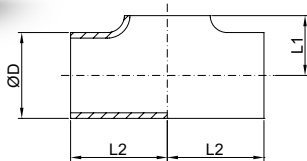

DIN

No.KST-P051

Size	D	L1	L2
DN10	12	7.5	26
DN15	18	10.5	35
DN20	22	12.5	40
DN25	28	16	50
DN32	34	19.5	55
DN40	40	22.5	60
DN50	52	30	70
DN65	70	39.5	80
DN80	85	47.5	90
DN100	104	58	100
DN125	129	70.5	187
DN150	154	83	225

焊接式三通  
Welded Tee(Long Type)

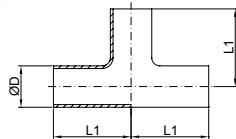

DIN

No.KST-P052

Size	D	L1
DN10	12	26
DN15	18	35
DN20	22	40
DN25	28	50
DN32	34	55
DN40	40	60
DN50	52	70
DN65	70	80
DN80	85	90
DN100	104	100
DN125	129	187
DN150	154	225

卡箍式三通  
Clamped Tee

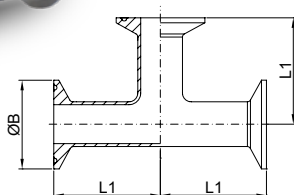

DIN

No.KST-P053

Size	B	L1
DN15	34	53
DN20	34	58
DN25	50.5	71
DN32	50.5	76.5
DN40	50.5	81.5
DN50	64	91.5
DN65	91	108
DN80	106	118
DN100	119	128